

THE PROP SHOP

EDEN PRAIRIE



2019 Annual Report



Contents

Key Gift from Lions Club	2
Kids' Coats Distribution	3
Celebrating Volunteers	4
Supporting Local Families	5
Our Volunteers	6
Our Donors.....	8
Financial Statements	10
Our Partners	12

Remodeled warehouse helps us reach new heights

We purchased our furniture warehouse in December 2014 for its 5,000 square feet. We were thrilled to have space to grow our furniture program and to increase our storage for off-season items. The front of the warehouse was sectioned into offices, and we used each one for excess and off-season goods (see incoming donations diagram).

In late spring 2019, we discovered a problem: mountains of stored items were growing in every corner. Shelves were overflowing with an abundance of seasonal clothing and holiday housewares/décor, and we thought we were past capacity for preserving donations for the appropriate time of year.

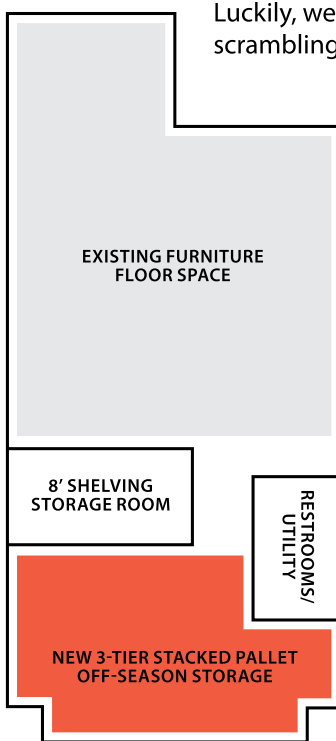

Luckily, we're accustomed to scrambling for space at the PROP Shop — our original building was also once sectioned by many walls — so we decided to open up the offices to enable pallet racking (see the red area in the building blueprint). In June 2019, we knocked down the walls and the ceilings. In July and August, we repainted the walls, removed carpeting, and reconfigured the lights and HVAC. By mid-August, pallet racking was up and operational.

Next, we needed a way to reach the top shelves safely, and we asked the Eden Prairie Lions Club Foundation for help to purchase the

necessary equipment. On Thursday, January 23, 2020, they presented us with funds for our new stacker which will lift pallets onto high shelves.

The Eden Prairie Lions and Eden Prairie Lioness Clubs have been strong supporters of the PROP Shop, and we appreciate their generosity to help us maximize our storage space. They have granted us significant funding since we began, including a large grant for our Family Services addition at our main building. The Lions and Lioness motto, is "We serve," and they have made a huge difference in our ability to serve local families with dignity.



Lions Club Foundation representatives toured the renovated warehouse and inspected the newly-delivered pallet stacker. Left to right: Vicki Bomben, Dan Ward, Gary Watkins, Gary Stevens, Lynn Swanson, Cindy Eddy, and Ron Case.

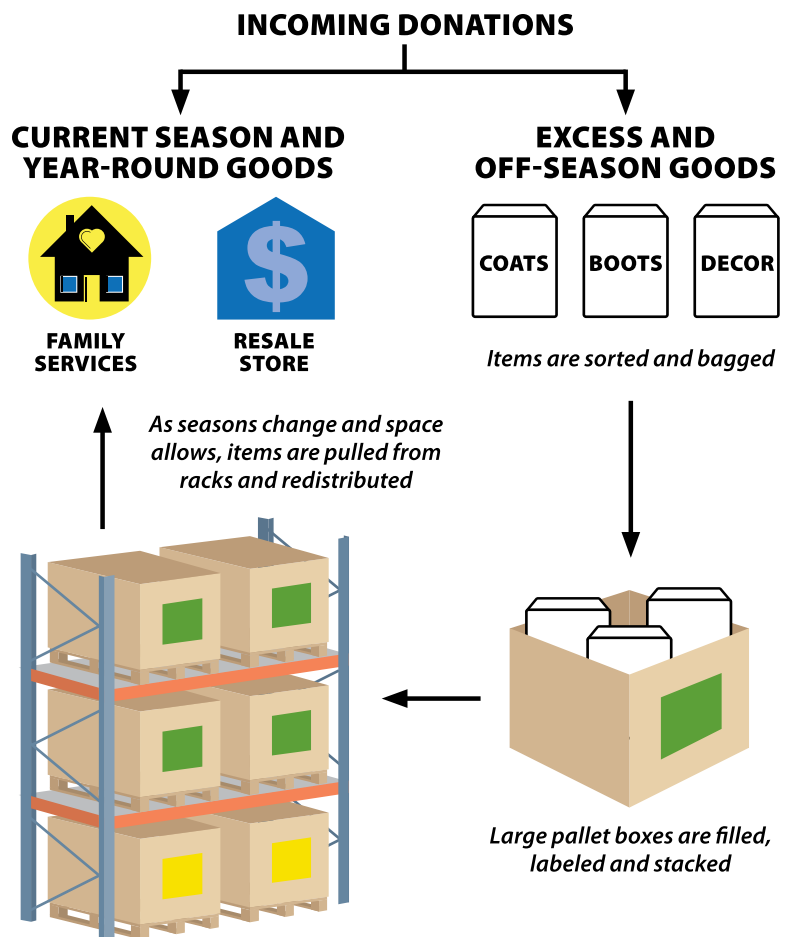

Community groups make generous contributions



Employees from MidCountry Bank helped assemble dressers in December 2019.

We often have groups ask us about volunteering, but space constraints and regular volunteers' schedules limit our ability to accommodate large numbers of people. While the furniture warehouse has added room for businesses and civic organizations to volunteer, we are not always able to find special activities for them.

In 2019, we asked the Eden Prairie Community Foundation (EPCF) for a grant to enable more group opportunities and to meet our furniture program's needs. EPCF provided funding to purchase ready-to-assemble dressers, which were then built by four different volunteer groups: the Young Men's Service League, Eaton Corporation, Elders from the Church of Jesus Christ of Latter Day Saints, and MidCountry Bank.

Over the years, we've had people volunteer from Grace Church, Target, UnitedHealth Group, the Eden Prairie Noon Rotary, and many other places. Groups have helped with a wide variety of projects from painting walls and building shelves to sorting coats, boots, and mittens for our annual kids' coats distribution. We appreciate all of our community's efforts to serve local families.

Since we opened, EPCF has helped us purchase our van, a washer, a dryer, computers, and more to improve our services. We thank the Eden Prairie Community Foundation for its ongoing support and for helping involve more people in the process.

2019 Kids' Coats Distribution

This year marked our 8th Annual Kids' Coats Distribution held at Immanuel Lutheran Church. Since 44 different coat sizes are required, we need a large space to display the 600+ requests for kids' coats each year. Families register for their kids' winter needs, and we bring hundreds of coats, snow pants, boots, hats, and mittens offsite for a three-day event each October.

We sort and inventory winter gear all year long, and over 45 volunteer shifts are required to set-up, run, and take-down the event. Throughout the rest of the winter, requests for adult coats and new families are filled through the Family Services Room.

Thank you to Immanuel Lutheran for providing space and refreshments to ensure all kids in our community are warm. Please donate your coats, snow pants, hats, boots, and mittens to keep this year-long effort strong for next winter, too!

Coat Distribution Numbers

100+ hours to accumulate, sort, inventory, and plan throughout the year

100+ volunteer hours in week of distribution

1,000+ coats given out each year (adults and kids)





Annual celebration for our great volunteers

The PROP Shop held its Annual Volunteer Appreciation Dinner on October 21, 2019, and over 100 volunteers came to celebrate. We had a great time at Buca di Beppo announcing achievements and revealing answers to PROP Shop trivia.

More than 400 volunteer hours are needed to keep us operational each week, so volunteers are spread out between many shifts. Our gathering helps everyone recognize how much effort it takes and how many people are involved in helping local families.

“It’s so fun to see everyone together and to celebrate what we do as a team.”

As of December 31, 2019, more than 3,100 people have volunteered over 223,000 hours. Volunteer and join us for the fun at the next Volunteer Appreciation Dinner!

A Note from Cindy

Looking back over 2019, I can say we continue to grow at an amazing pace. Last January, everyone was talking about *Tidying Up with Marie Kondo*, and we saw overwhelming donations during a typically quiet time of year. However, even before the show and book became popular, we had more business than usual.

This amazing generosity from the community led to remodeling our storage space. An informed shopper suggested tearing down the offices’ ceiling in our warehouse so we could use pallet racking. I knew immediately it was the solution, and we began a remodel within the month. By the end of the summer, we had increased our storage capabilities by more than 300%. We’ve always been nimble, and we keep adapting to new challenges.

We served a record number of families last year, and in May 2019, we delivered our 2,000th bed. It takes a huge effort to keep us stocked for families’ needs, and we depend on donors and volunteers to do it all. One mother wrote us, *“I get to take care of the family thanks to you.”* We are making a difference and ensuring families in our community have what they need to thrive.

“So grateful for this Family Service. Winter clothes, coats, boots, summer clothes, shoes, socks, boxers, and toys/gifts for my kids. Blessings to your organization.”

“Thank you for the new warm scarf. It was so cold this morning. Thank you for donating every little thing. It can mean so much.”

We had tremendous support this year from the individuals, businesses, foundations, and schools which volunteered, donated, shopped, and spread the word. Thank you for all you do!

—Cindy Eddy
Executive Director

MORE WAYS YOU CAN HELP

- Community Group Liaison
- Donation Drive
- Secret Shoppers
- Estate Sale Team
- Treat Bakers

For complete descriptions of these opportunities and more, visit propshopep.org

Filling homes and hearts with your support

Security and hope are critical for families experiencing tough times. One woman wrote us, *"What a difference PROP Shop has made in our lives: My children have boots, coats, and snow pants. They have shoes, pants, shirts, socks, underwear, sports equipment, and new toys. They don't get teased at school because of their clothes or their lack of nice things. Thank you, thank you, thank you."* Your support makes a difference beyond the tangible items. Thank you for making our programs possible.

2019 Service Statistics



We served **743** families with clothing, household goods, and/or furniture.



We provided **16,497** bags of clothing and household items (over 100,000 individual pieces).



We gave **10,670** pairs of new socks and 10,224 pairs of new underwear to local kids and adults.



We delivered **190** beds, 120 dressers, 41 tables and chairs, and 27 couches to 173 different families.



We provided **499** special request items through our Secret Shopper program (work boots, sports equipment, and other specific needs).



The Family Services area was visited **4,172** times in 2019.

In total, we provided more than \$409,000 worth of clothing, household goods, and furniture to local families in 2019.

ONGOING FAMILY SERVICES NEEDS

Please check our website at propshopep.org/donations to see a list of urgently needed items. We are always looking for more:

- | | |
|----------------------|-----------------------------|
| • Kids' clothes | • Bowls |
| • Kids' tennis shoes | • Silverware |
| • Coats | • Blankets |
| • Snowpants | • Sheets |
| • Waterproof mittens | • Towels |
| • New socks | • Beds |
| • New underwear | • Dressers |
| • Pots and pans | • Kitchen tables and chairs |





2019 PROP Shop Volunteers

Colleen Aaberg
Lily Aaberg
Sam Aaberg
Jody Aafedt
Payton Aafedt
Alex Abbott
Smitha Abbott
Hamza Abdi
Muhayo
Abduqodinova
Carol Ahrendt
Aditya Akolkar
Mary Aksoz
Maria Alleman
Nadia Alleman
Juliana Allen
Karen Allen
Ken Allen
Sasha Allen
Scott Allen
Susan Allen
Tammy Allison
Annette Anderson
Becky Anderson
Gloria Anderson
Henry Anderson
Molly Anderson
Tracy Lynn Anderson
Hardy Armstrong
Lisa Ashley
Jodi Ayers
Laura Babin
Brooke Barbee
Oumou Barry
Brady Baynes
Michelle Baynes
Rose Baynes
Allison Beck
Katie Becker
Meghan Becker
Pam Becker
Pat Bell
Kristi Benson
Leif Benson
Jacob Berger

Brianna Simmons
Bergin
Olivia Bergin
Owen Berkholtz
Beth Billstrom
Mark Billstrom
Kathy Blackford
Hannah Blackwood
Megan Blackwood
Leslie Kim Bock
April Bockin
Shawn Boegeman
Kassie Boller
Roy M Boone
Matina Borggreve
Pam Borgman
Barbara Brandt
Kayla Brattensborg
Robbie Breese
Bennett Breyer
Katie Brown
Samantha Brown
Tony Brown
Joanne Burris
Anne Byrne
Angie Bystrycki
Brynna Bystrycki
Jeannie Campbell
Mariann Cannon
Grace Carlson
Jennifer Carlson
Linda Carlson
Marcia Catt
Paxton Catt
Kurian George
Chandy
Sunny George Chandy
Ava Chen
Dominic Chione
Susan Chione
Irene Cho
Colleen Choles
Chrestomathy
Hannah Christenson
Lesley Christenson

Sofia Clawson
Emma Coburn
MacKinnie Coburn
Melissa Coburn
Christa Coleman
Emily Compton
Pamela Cook
Kristina Cooke
Jayne Dakay
Tanner Daniels
Tanya Danilchick
Cindy Dawson
Liz Dayton
Mary Dayton
Ashley DeGrange
Jodi Dehler
Angelina Deinhardt
Sheryl DeWitt
Jackie DeZellar
Juan Diaz
Patricio Diaz-Munoz
Kaden Dixon
Anna Dorson
Carrie Dorson
Barb Dunn
Bob Eddy
Lisa Eddy
Emily Eddy-Theis
Eric Educate

Kathy Educate
Jenn Educate Stranik
Laurie Egan
Julie Eidem
Jenny Ekeren-Holm
Jack Ekholm
Janelle Ekness

Lillian Ekness
Midge Elder
Davis Eldridge
Lucia Eldridge
Deborah Elhardt
Grant Eller
Deb Elliott
Alanna Epping
Kellie Erickson
Alayna Erpelding
Deanne Erpelding
Abby Farniok
Ewan Farrell
Jane Farrell
Jo Farrell
Kaitlyn Farrell
Lisa Farrell
Megan Farrell
Nathan Felsing
Sophie Felton
Donna Fiedler
Austin Finney
Carole Fitzsimmons
Rändi Flagstad
Beth Fletcher
Lauren Fletcher
Jake Freeland
John Freytag
Ellie Friel

Sue Friend
Liam Fronek
Lisa Fronek
Megan Fronek
Ben Frost
Michael Frost
Sarah Frost

Mark Fuller
Dale Garton
Raphaela Garton
Gena Gerard
Alix Giffin
Nancy Giffith
Cynthia Gitzen
Griffin Goetze
Kristin Goetze
Will Goetze
Kristine Goldman
Kate Gorski
Sue Gorski
Janice Gould
Sue Grady
Jenna Lynn Graff
Karen Graff
Gretchen Grey
Mary Griffiths
Tommy Griffiths
Kelly Gross
Michael Gross
Carol Gschwendtner
Lydia Gschwendtner
Kim Guild
Mackenzie Guild
Maria Gujan
Avery Hackenberg
Carole Hackenberg
Jean Hafdal
Tara Hall
Elizabeth Hamilton
Sarah Hamilton
Kathleen Hanahoe
Ryan Hanahoe
Abby Hansen
Kathy Hanson
Derek Hanus
Jean Hardman
Carol Harmer
Elyse Harris
Julia Harris
Sam Harris
Johnny Hartle
Julie Hartle

Bobby Heiberg
Sarah Heiberg
Stephanie Heiberg
Sara Heim
Christine Heinzeller
Kyle Heinzeller
Darlene Helmer
Dori Helmer
Ryan Herbert
Ryan J Herbert
Daniela Hernandez
Michael Hernandez
Cindy Hewitt
Ron Hewitt
Diane Hilleman
Jan Hillius
Cindy Hoaglund
Mary Hoch
Nathan Hoefflin
Bonnie Hoghaug
Doreen Hohag
Amber Holm
Connor Holm
Hattie Homan-Syvruud
Abby Hondlik
Michael J Hondlik
Eric Howard
Kerri Howard
Wanda Howard
Zach Howard
Philip Hsueh
Skailer Huffman
Liz Hustad
Lilly Hyland
Mary Hyland
Isaac Isiko
Ahmad Jabri
Halimo Jama
Jean Jenderko
Tyler Jenkins
Brendan Jennen
Gabriela Jensen
Joseph Jerstad
Reshma John
Abbe Johnson

**594 volunteers gave more than
21,250 hours of their time in 2019.
Thank you all!**

2019 Volunteers, continued

Alexis Johnson
Allison Johnson
Claire Johnson
Ethan Johnson
Jim Johnson
Kathie Johnson
Kirsten Johnson
Maddie Johnson
Nicolette Johnson
Sara Johnson
Steve Johnson
Terri O. Johnson
Maggie Jones
Marcia Justic
Stacy Kabele
Ian Kalal
Quinn Kalal
Zachary Kalal
Ember Kapitan
Teri Karels
Sharon Karkanen
Jaxon Karl
Kavya Karthic
Katherine Kashevatsky
Betty Kirchner
Lacie Kniefelkamp
Don Kniffen
Donna Kniffen
Kaelyn Knudtson
Kathy Knutson
Julie Kolbow
Therese Kosch
Kelley Kosmides
Tarun Kothandaraman
Anoushkha
Koutharapu
Beth Kreusch
Stephanie Kruger
Wan-Chong Kung
Mason Lang
Ronnie Langston
Debbie Larson
Nick Larson
Christine Lasley
Lonnie Lassman
MaryBeth Lassman
Gerry Lattimore
Suzanne Leblanc-
Marshall
Chaehyun Lee
Jeffrey Leppart
Thomas Lesnikowski
Catie LeTexier
Valerie Leuthard
Andy Li
Kathy Link
Larry Link
Noreen Linney
Tommy Lisko
Maggie Lobsinger
Cheryl Locke

Andrea Lopezmalo
Dallas Love
Dillan Love
Susan Lovering
Garrett Lozier
Raleigh Lucas
Gabriella Lucs
Sophie Lunda
Lana MacCarthy
Ciaran Macken
Lesley Macken
Mary Mackmiller
Claire Mader
Allie Maloney
Kathi Margo
Kenna Markle
Zach Marks
Ava Martin
Emily Martin
Tiffany Martindale
Joe Martineau
Max Matsui
Joseph Mattson
Beth McCartan
Colin McCartan
Tyler McIntee
Mary Jo McMahon
Nancy McNeill
Jenna Meeks
Wayne Meger
Kay Mendyke
Tommy Mendyke
Nunanee Meng
Jacob Menth
Megan Meyer
Courtney Mikol
Debra Mikol
Kim Miller
Marianne Miller
Mark Miller
Kendall Minta
Ronald Mishieu
Hamdi Mohamud
Evan Mohan
Madhan Mohan
William Morris
Fozia Muhumed
Kaylee Munger
Lila Munger
Frannie Murphy
Nick Murray
Justine Myers
Terri Myers
Sarah Mynran
Neil Namjoshi
Ngawang Namru
Marilu Narem
Heather Nelson
Judie Nestaval
Abbie Winn Neumayer
Sheri Neumayer

Hanna
Neumiarzhytskaya
Michelle Nguyen
Deborah Nielsen
Cindy Nitzsche
Jayne Nocton
Dottie Norlander
Derek Normann
Saria Noyes
Emma O'Connell
Maggie O'Connell
Mary Jean Ogdahl
Hope Oliva
Annette Olson
Dolores Olson
Janice Olson
Judy Owens
Raleigh Page
Will Pahl
Karina Papa
Blake Parker
Catherine Parker
Daniel Parker
Nick Parker
Seema Pathak
Sreya Patri
Sarah Paulus
Susan Paulus
Samanthe Payne
Mason Pecci
Nicholas Pehrson
Allie Pemantell
Julie Pemantell
Tessa Pemantell
Ron Pergande
Trisha Pergande
Jen Peruzzi
Jackie Peters
Jacob Peterson
Leif Peterson
Riley Peterson
Sarah Peterson
Sharon Peterson
Diane Pflepsen
Phil Pflepsen
Michelle Phan
Lindsey Phillips
Deb Plager
Steven Plager
Ben Ploof
Jacqueline Ploof
Michelle Pokrzywinski
Sami Pomar
Terri Powell
John L. Price
Jennifer Quast
Crystal Quiring
Mary Quiring
Kathie Radcliffe
Adalyn Raney
Laura Raney

Amirah Razman
Kelley Regan
Ajith Regulagedda
Carrie Reineccius
Carol Reinhart
Samantha Resendiz
Alondra Resendiz
Saucedo
Mary Reuss
Jovie Rice
Kristen Rice
Emma Richter
Tina Richter
Allie Rieder
Anita Rieder
Anne Ringquist
Brady Rorke
Linda Rorke
Pete Rose
Barbara Roushar
Mary Rudin
Lauren Rupp
Jody Russell
Laurie Ryan
Matthew M Sabotta
Ananya Sagi
Katie Samide
Gaby San Miguel
Jean Sanchez
Maya Sande
Megan Sande
Dallin Sanders
Judy Sanvick
Jon Sather
Leigha Sather
Sue Schadow
Kay Schaffler
Lynne Schaffler
Kayley Scherer
Peggy Scherer
Curtis Schiebel
Claire Schommer
Lisa Schumann
Donna Schwab
Doug Schwab
Robyn Scott
Barb Scrimgeour
John Seibert
Pam Seibert
German Semenov
Liliya Semenova
Cole Severson
Vanita Shah
Emma Sheehan
Kate Sheehan
Katrina Sheldon
Keegan Shimley
Renee Shimley
Aparna Shoney
Lynn Simmons
Beth Simonsen

If you volunteered in 2019 and cannot find your name, we apologize for the oversight. Please let us know and we will fix it for next year.

Caroline Skaar-Page
Madeline Skoglund
Celia Skubic
Erin Skubic
Anne Smith
Silvia Smith
Barbara Smyth
Peter Smyth
Fred Soman
Akshaya
Somasundaram
Deann Speltz
Joy Spencer
Jackson Sperry
Sherri Sperry
Sarah Spiegle
Susan Spiegle
Nancy Springer
Pranaav Srinivasan
Ashley Stahl
Karen Stahl
Maria Steblay
Ian Stelter
Stacey Stelter
Jen Stephens
Summer Stephens
Josh Stewart
Susan Stewart
Ellie Stoffel
Jacob Stoffel
Molly Stoffel
Amy Strezo
Luke Strezo
Gail Stroinski
Augie Stukenborg
Sophie Stukenborg
Carol Suggs
Andree Swanson
Jim Sylvestre
Dawson Syvrud
Malachi Talamantes
Siri Tangeti
TASSEL
Cara Terwilliger
Charlie Terwilliger
Kyle Theis
Rian Thibeau
Amy Tinklenberg
Lisa Toomey
Ivy Tran
Justin Trautwein
Autumn Tysk
Soleil Tysk
Joe Udvari

Grace Urban
Jacob Van Dusen
Renee Van Dusen
Tyler Van Dusen
Amber Vanlaecken
Nina Varghese
Pamela Vega Rubio
Maggie Venell
Bella Veyria
Karla Viland
Cheryl Vinson
Alexandra Vitko
Brett Voltin
Maureen Voltin
Emily Vu
Nancy Wagner
Nicholas Walfrid
Linda Wallace
Julia Wang
Sheila Ward
Lori Washburn
Jeanne Waslosky
Pat Wassink
Jean Way
Rich Weaver
Susan Weaver
Annette Weber
Carol Webster
Nancy Weinrich
Ryan Wellner
Diane Wells-Nash
Pat West
Erik Westenfield
Joan Whetston
Emma Whittemore
Sam Whittemore
Gracie Wilker
Ellen Winderl
Sadie Witterschein
Cynthia Wizner
Clara Woods
Jill Woods
Sydney Wrobel
Danny Xu
David Xu
Cathy Yamoor
Jasmine Yan
Dylan Yang
Reta Yearby
Nick Yost
Katelyn Zick
Rose Zwettler



Thanks to our 2019 Donors

3M

Cheryl Ahlcrone
Betty & Robert Ahlgren
Julia Akins
Susan & Ken Allen
AmazonSmile
American Family Insurance
David Anderson
David & Joan Anderson
Penny Anderson
Roger & Donna Anderson
Susan Anderson
Tracy Anderson
Anonymous
Srinivas Vadrevu &
Pemmeraju Aparna
Jan & Greg Aplin
Dolores Arnold
Gordon Aspnes
Mike Atkinson
Janene & John Augustine
Paul & Eileen Bailey
Sue & Daniel Battcher
Pam & Robert Becker
David Beneke

William & Jo Benson
Steven Dittes & Kathy Berg
Gary & Helen Bergren
Kathleen Bernhardson
Blackbaud
Kathy & Gary Blackford
Frederick Bock
Vicki Bomben
Gary Bork
Nancy Bothwell
Jill Boyd
Dan & Mari Bray
Andrea Breckner
David & Imelda Breese
Laura Braidall
Joel & Marianne Brenckman
Amy & Ted Browne
Anne & Pat Byrne
Jeannie Campbell
Carol Cansdale
Cargill
Mary Carlson
Susana & Matthew
Carpenter
Barbara & Michael Carroll

Sandra Chabot
Patricia Chisenhall
Delrae & Jack Chivers
Mark & Marilyn Christianson
Betty Clark
Kathryn Clark
Laurie Coleman-Lankford
Curt & Rita Conrad
Randie Cook
Matthew Corti
Vasilisa Costin
Lynne Crist
Gail Critchfield
Penny Deam
George & Janet Dean
Natalie DeKam
Heidi & Brian Dockter
Cindy Doms
Paul Dove
Marcia Drew
Driasi
Cindy & Dennis DuBois
Ann & Christopher Duppler
Susan Dyer
Maxine Eddy
Robert Edelstein
Eden Prairie Community
Foundation
Eden Prairie Lioness Club
Eric & Kathy Educate
Laurie & Jim Egan
Julie & Joel Eidem
Deb & Mark Elliott
Nola & Calvin Engelstad
Danielle & John Engholm
Alanna Epping
Patrice Erickson
Robert Ericson
Cindy & Randy Evert
Betty Lou Falkman
Lynn & Bradley Featherstone
M Sue Feigal-Hitch
Nancy & Rod Fisher
Randi Flagstad
Maureen Flavion
Katharine Foley

Navigate Forward
Daniel Fuchs
James Fussy
James & Barbara Gabbert
Jack & Avis Galleger
Susan & Robert Gammill
William Gardner
Raphaela & Dale Garton
Paula & Eames Gilmore
Sarah & Robert Gorski
Graco
Sue Grady
Sarah Nickolay Gray
Tina Grigsby
Jody & James Grossman
Larry & Barb Groves
Kelly Gustafson
Mary & Kevin Gustafson
Debra Halbert
Brandi & Jeff Hall
Marcia & Thomas Hallet
Kathleen Halloran
Brian & Debbie Hansen
Pat Hanson
Roxanne Hanson
Christine Harris
Ralph & Susan Harrison
John & Jen Hatlevig
Jill Haverkamp
Sandy Hayden
Allina Health
Christine Heinzeller
Drucilla Henderson
Nancy & Curtis Hendrickson
Patti J. Henry
Jacquelyn Hentges
Felix & Sarah Hernandez
Victor & AnnMarie
Hernandez
Rebecca Herreid
Jean & David Hess
Barbara & Jeff Higgins
Margaret Hoff
Doreen Hohag
Michael Holm
Katherine Holschuh

Susan Holt
Carol Hooker
Garry & Tina Housker
Natalie & Robert Hunter
Linda & David Huntley
Bruce & Terry Hutchins
iHeartMedia
Margaret Iverson
Robin & Jerry Janzen
Jerstad Family Foundation
Sharon Jibben
Meryl & Bonnie Johnson
Morley Johnson
Steven Johnson
Tom Johnson
Deborah & Allen Jones
Fredric Joseph
Cindy & John Joyce
Kiandra Judge
Mary Junge
Junk King
Anirudh Kakanavaram
Cheryl Kamps
Elizabeth Santiago &
Anthony Kantar
Ember Kapitan
Jeanne & Robert Karschnia
Deb & Rick Karulf
Erik & Mandie Karulf
Judith & Howard Kauffman
Jill Kennedy
David Eddy & Joan Kermath
Dr. Michael & Diana
Kilpatrick
Jeffrey Kirst
Martha & Brad Kissell
Greg Konkel
Attila Konkoly
Paula Koshmrl
Kelley & Paul Kosmides
Lynn Krafve
Barbara Kruttsch
Betty Kuechle
Ron & Mary Lou Lamberton
Raymond Lamovec
LARK group

Special Gifts

In honor of:

Steven Aasgaard	Michelle Pokrzywinski
Susana & Matthew Carpenter	Kyle Rose & Nancy Russ
Judy Folstad	Barb Roushar
John & Jen Hatlevig	Kathryn Senn
Janelle Hegrenes	Jeffery Sepesi
Suzanne Meyers	Ames Sheldon
Sharon Moten	Dan & Sheila Ward
	Susan & Rich Weaver

In memory of:

Marge Kramer	Rose Stuhlman
Ace Palm	Sandra Thompson



2019 Donors, continued

Gerry & Bob Lattimore
 Laura & Timothy Lebens
 Nicole & Ronald Lemmerman
 Tim & Mary Lenker
 Denny & Jeanne Lind
 Linda & Daniel Lindahl
 Thomas & Helen Lockhart
 Bernadette & James Luhman
 Lana MacCarthy
 Mary & Mark Mackmiller
 Nancy Maleska
 Kathi & Terrence Margo
 Joshua Marin
 Kay & Donald Mariotti
 Marcia Marshall
 Marilyn Martinsen
 Sarah, Jim, Joe, & Grace Mattson
 Sharyn & Doug McChane
 Ilene & Jay McCluskey
 Stephanie McNally
 Gary Meier
 John Menden
 James Meservy
 Paul & Lesley Meyer
 Suzanne Meyers
 Marianne & Jeff Miller
 Michael & Nancy Miller
 Shawna Miller

Michael Mirvis
 Darvin Mischke
 Robert Mizell
 Nelson Moore
 Mike & Patricia Moriarty
 Reginald Mosior
 Douglas & Jane Nemecek
 Valarie Neubarth
 Douglas Niemer
 Dottie Norlander
 Sharon Olsen
 Annette Olson
 Sandie & Marvin Oman
 Kathy & Paul Orner
 Judy Orrick
 Holly & Jeff Parker
 Adam Patil
 Clifton & Georgene Ann Perkins
 Jackie Peters
 Kathryn & Gary Peterson
 Bruce Petz
 Josh Pfeifle-Weber
 Kyle Pfeifle-Weber
 Debbie & Steven Plager
 Christine Poague-Short
 Michelle & Darren Pokrzywinski
 Ken & Debra Potter
 Debra & Ben Preece
 Jacalyn Prentice

Wendy Price
 Julia Prinz
 Elizabeth & Richard Puckett
 Sallie Quan
 Heidi & Patrick Quirk
 Dawn Rademacher
 Michelle Rasmussen
 Peter Rasmussen
 Carrie Reineccius
 Mary Reuss
 Diane & Alan Reuteler
 Joan & Curt Reynders
 Nancy Rions
 Charlie Jean Robbins
 Zoe Robinson
 Chuck Rodman
 Linda & Joe Rorke
 Kyle & Pete Rose
 Wayne & Jennifer Rosengren
 Darci & Darrin Rothstein
 Carol Rueppel
 Lori & Ross Ruschmeyer
 Renee & Jamal Rushdy
 Dan & Cindy Ryan
 Bob & Karen Ryder
 Mark & Leann Sand
 Kathleen Sarles
 Thomas Scheller
 James & Jacqueline Schmidt
 Patricia Schmidt

Kit & Dick Schmoker
 Jill Schroeder
 Carol Schuette
 Robyn Scott
 Barb & Bill Scrimgeour
 Marilyn & Richard Seeler
 Heather Seigler
 Amy Sellheim
 Jeffery Sepesi
 Scott Sexton
 Greg Shaughnessy
 Don & Barb Shaw
 Peter Sikowski
 Susan Singlestad
 Sharon Singsass
 Glen & Shirley Sivertson
 Barbara & Peter Smyth
 Susan Beerhalter Soule & Gary Soule
 Lynn Speaker
 Deann & Joseph Speltz
 Nancy Springer
 Stacy
 Charles & Jean Stark
 Andrew Stevenson
 Paul Stibal
 Joe & Carol Stoeber
 Charles & Rochelle Stone
 Leslie Stovring
 Dianne Strandberg
 Gail & Craig Stroinski
 Carol & David Suggs
 Sheila Sullivan
 Scott & Sue Takekawa
 Donna Talley
 Robert Taylor
 The Minneapolis Foundation
 The Quaker Hill Foundation
 Jenna Theis
 John Thompson
 Kevin Thompson
 Thrivent Financial
 Julie & John Trabant
 Mary Beth Trine
 Kathy Ulmer

UnitedHealth Group
 John & Jennifer Urbanski
 Valerie Vadnais
 Vince & Kris Vanella
 Van't Hoff Memorial Fund
 John & Cynthia Veire
 Janet Veith
 Arlene Vernon
 Cheryl Vinson
 Jeanne & Larry Voehl
 Kay & Mark Wall
 Linda Wallace
 Dawn & TJ Wallin
 Dan & Sheila Ward
 Roger Watchorn
 Gary & Jeanille Watkins
 Carol & Bob Webster
 Nancy Weinrich
 Harvey Weiss
 Judith & Darrell Westby
 Don & Joyce White
 Kevin & Mary Wilde
 Tanya Wilde-McPherson
 Andrew Wilkey
 Daisy Williams
 Jim & Roxanne Williams
 Juli Williams
 Ann Williamson
 Margaret Williamson
 Michelle Williamson
 John & Linda Wilson
 Erica Winegar
 Susan Winn
 David Winquist
 Richard Woitte
 Jeanne Wolfe
 Sharon Wolfe
 Brenda Wood
 David Wood
 Kari & Bradley Wragge
 Malyn Wrobel
 Reta & William Yearby
 Theresa Zangel
 Chris & Susan Zaugg
 John & Linda Zimmerman



In 2019, 357 donors gave funds so we could meet the needs of local families. We apologize for any oversights; please let us know so we can fix any errors.



Statement of Financial Activities

	Years ended December 31, 2019 Total*	2018 Total
SUPPORT AND REVENUE		
Support		
Grants and donations	\$116,662	\$109,624
Government support	\$20,000	—
In-kind contributions	\$3,900	\$830
Interest	\$837	\$313
Total Support	\$141,399	\$110,767
Program Revenue		
Contributions of merchandise	\$1,754,128	\$1,712,846
Sales of donated merchandise	\$715,128	\$641,983
Less value of merchandise sold	\$(715,128)	\$(641,983)
Net Program Revenue	\$1,754,128	\$1,712,846
TOTAL SUPPORT AND REVENUE	\$1,895,527	\$1,823,613
EXPENSES		
Programs	\$1,688,550	\$1,636,057
Management and general	\$108,638	\$104,365
Fundraising and development	\$41,884	\$37,105
TOTAL EXPENSES	\$1,839,072	\$1,777,527
CHANGE IN NET ASSETS	\$56,455	\$46,086
Net assets, beginning balance	\$1,591,569	\$1,545,483
NET ASSETS, ENDING BALANCE	\$1,648,024	\$1,591,569

*Unaudited



Statement of Financial Position

	2019*	December 31, 2018
ASSETS		
Current Assets		
Cash & cash equivalents	\$407,058	\$376,184
Accounts receivable	\$14,071	\$2,674
Grants receivable	—	—
Inventory	\$134,125	\$139,006
Prepaid expenses	\$2,670	\$3,727
Total Current Assets	<u>\$557,924</u>	<u>\$521,591</u>
Fixed Assets		
Land	\$321,000	\$321,000
Land improvements	\$107,501	\$107,501
Building	\$1,079,938	\$1,075,625
Vehicles	\$21,628	\$17,728
Furniture, fixtures, equipment	\$37,336	\$31,935
Software	\$12,100	\$12,100
	<u>\$1,579,503</u>	<u>\$1,565,889</u>
Less accumulated depreciation and amortization	<u>\$(296,403)</u>	<u>\$(254,403)</u>
Total Fixed Assets	<u>\$1,283,100</u>	<u>\$1,311,486</u>
TOTAL ASSETS	<u>\$1,841,024</u>	<u>\$1,833,077</u>
LIABILITIES AND NET ASSETS		
Current Liabilities		
Accounts payable	\$9,323	\$5,881
Accrued wages and benefits	\$32,830	\$33,662
Accrued liabilities	\$3,249	\$3,327
Current portion of long-term debt	\$27,236	\$25,241
Total Current Liabilities	<u>\$72,638</u>	<u>\$68,111</u>
Long-Term Debt		
Mortgage note payable	\$120,362	\$173,397
Total Long-Term Debt	<u>\$120,362</u>	<u>\$173,397</u>
Net Assets		
Without donor restrictions	\$1,626,645	\$1,572,796
With donor restrictions	\$21,379	\$18,773
Total Net Assets	<u>\$1,648,024</u>	<u>\$1,591,569</u>
TOTAL LIABILITIES AND NET ASSETS	<u>\$1,841,024</u>	<u>\$1,833,077</u>

*Unaudited



Thank You to Our PROP Shop Partners!

The PROP Shop deeply appreciates its relationships with the following organizations who partner with the PROP Shop in a variety of ways as donors, volunteers, and supporters.

3M	Eden Prairie Women of Today	Pieper Hope and Courage Foundation
Allina Health	Edina Realty	Prairie Dental Group
AmazonSmile	EPHS Band	Prairie Lutheran Church
American Family Insurance	EPHS Key Club	Preserve Association
Ameriprise Financial	EPHS National Honor Society	Primrose School
Anne McGilvray Co.	G & S Estate Sales	Priorities2
Anytime Fitness	Gold Mine Estate Sales	People Reaching Out to People (PROP)
Belladonna Florist	Grace Church	Pure Tech Solutions
Cargill	Graco	Redstone
Caspari	Hampton Inn	Restwell Mattress Factory
Chanhassen Lions Club	HealthSource Chiropractic	Sailers Greenhouse
Chanhassen Villager	Heartland America	Sapphire Consulting
Chrestomathy	Howard's Jewelry, Inc.	Sign Source
City Hill Church	iHeartMedia	St. Albans Church
City of Chanhassen	Immanuel Lutheran Church	St. Andrew Lutheran Church
City of Eden Prairie	Jerstad Family Foundation	Suburban Waste Service
Cub Foods	J. Jill	Summit Place
Dell, EMC	Junk King	Talia Imports
Driasi	Justice Brothers	Target Corporation
Eaton	Keller Williams Realty	TASSEL
Eden Prairie Beyond the Yellow Ribbon	Kim Teavor & Company	Tavern 4&5
Eden Prairie Center	LARK groups	Theos Company
Eden Prairie Community Band	Maple Crest Landscape	Thrivent Financial
Eden Prairie Community Center	Margot & Louise	Thunder Communications
Eden Prairie Community Foundation	Marshall's Farm Market	Top Tier Estate Sale
Eden Prairie Library	Menards	TurnStyle
Eden Prairie Lifestyle Magazine	MidCountry Bank	UNFI
Eden Prairie Lions Club	The Minneapolis MART	UnitedHealth Group
Eden Prairie Lioness Club	Minuteman Press	Valley Art Group
Eden Prairie News	National Charity League	Vickerman Company
Eden Prairie A.M. Rotary	New Comers Club	Winnebago Industries
Eden Prairie Noon Rotary	Nothing Bundt Cakes	Young Men's Service League
Eden Prairie Schools	Oak Knoll Lutheran Church	
	Once Upon a Child	
	Pax Christi Catholic Community	

THANK YOU to 8,500+ donors who gave items from their homes in 2019.

Thank you to volunteer Sue Schadow for again donating photography and graphic design for this annual report.

Staff Members

Cindy Eddy
cindy@propshopep.org
Executive Director

Vicki Bomben
vicki@propshopep.org
Operations Manager

Alicia Yost
alicia@propshopep.org
Volunteer Coordinator

Carrie Reineccius
Family Services Co-Coordinator

Kyle Rose
Family Services Co-Coordinator

Julie Musech
Warehouse Coordinator

Christine Poague-Short
Training Coordinator

Phetsy Locke
Store & Donations Coordinator

Vasilisa Costin
Store & Donations Coordinator

Ann Berne-Rannow
Store & Donations Coordinator

Dan Ward
Facilities & Donations Coordinator

Board Members

Cindy Eddy, Executive Director

Kathy Educate, President

Anne Byrne, Vice President

Lisa Toomey, Treasurer

Barb Scrimgeour, Secretary

Sharon Peterson

Susan Weaver

Mary Mackmiller

THE PROP SHOP
EDEN PRAIRIE



Store Hours and Donation Hours

Monday..... 10 a.m. to 5 p.m.

Tues, Wed & Thurs 10 a.m. to 7 p.m.

Friday & Saturday 10 a.m. to 5 p.m.

Sunday..... 12 noon to 5 p.m.

Due to our space limitations, please call or email ahead regarding furniture donations.

propshopep.org

THE PROP SHOP
15195 Martin Drive
Eden Prairie, MN 55344
952.934.2323
info@propshopep.org